

# HAND WINCHES



Pulling crab winches, gear type

## Ref 659

600 kg to 10 t



2 tons



10 tons



5 t with hand wheels  
(special model)



# HUCHEZ

# PULLING CRAB WINCHES

## Use: pulling

- Anchorage and movement of barges, boats, ferries
- Pulling of vehicles, wagons, boats, etc
- Doors manoeuvring
- Pulling work requiring long lengths

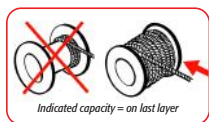

## Technical properties:

- High capacity of up to 10 tons.
- Steel chassis and drum.
- Straight cut gearing, high tensile steel.
- Rugged and tested mechanical construction.
- Manual band brake (lever or wheel).
- 2 speeds, disengageable (except on 600 kg model).
- Large rope capacities.
- Standard crank handle, maneuvering hand wheel as an option.
- Marine painting as an option.



# Technical specifications and dimensions

## Models 600 kg to 3 t

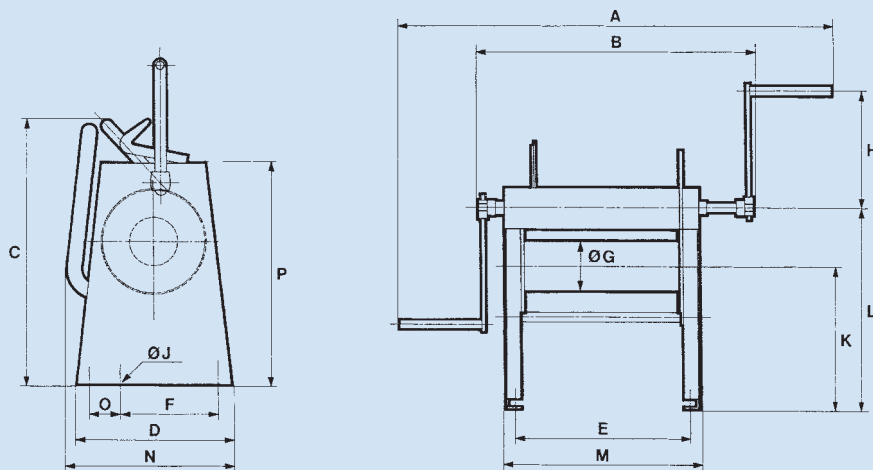

Capacity kg	A mm	B mm	C mm	D mm	E mm	F mm	Ø G mm	H mm	Capacity kg	ØJ mm	K mm	L mm	M mm	N mm	O mm	P mm	Lg mm
600	1235	715	770	460	460	310	133	360	600	15	460	605	515	440	50	645	400
1500	1322	802	870	480	524	330	133	360	1500	20.5	490	680	580	500	50	705	450
2000	1415	895	890	500	580	320	168	360	2000	20.5	470	660	645	520	100	720	500
3000	1800	995	1030	600	677	380	168	480	3000	22	477	707	745	610	100	780	600

Capacity kg	Number of speeds	Rope dia mm**	Capacity drum m	Number of layers	Travel per crank revolution (mm)	Weight kg
600	1	5	346	8	88.5	70
1 500	2	8	81	4	90	85
2 000	2	10	169	5	78	110
3 000	2	11.5	138	4	88	170

The indicated rope diameter corresponds to the capacity on the last layer.

\*\* Breaking load coeff. = 3

## Model 5 t

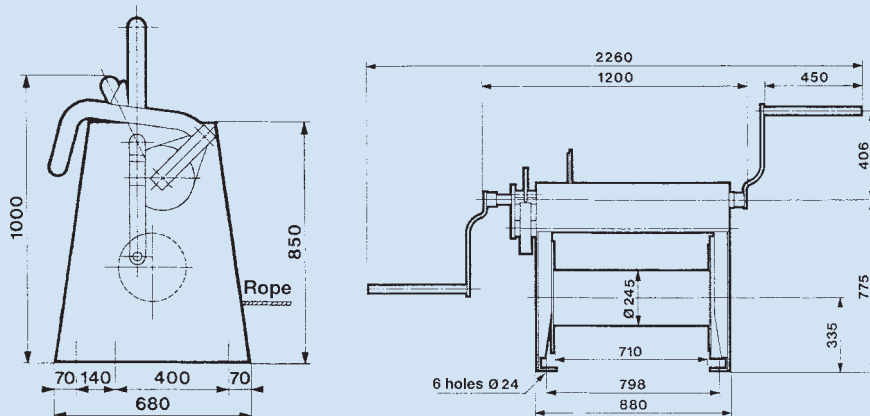

Capacity kg	A mm	B mm	C mm	D mm	E mm	F mm	Ø G mm	H mm	Capacity kg	ØJ mm	K mm	L mm	M mm	N mm	O mm	P mm	Lg mm
5000	2260	1200	1000	680	798	400	245	406	5000	24	335	775	880	-	140	850	710

Capacity kg	Number of speeds	Rope dia mm**	Capacity drum m	Number of layers	Travel per crank revolution (mm)	Weight kg
5 000	2	16	223	5	44	360

The indicated rope diameter corresponds to the capacity on the last layer.

\*\* Breaking load coeff. = 3



# Technical specifications and dimensions

## Model 7.5 t

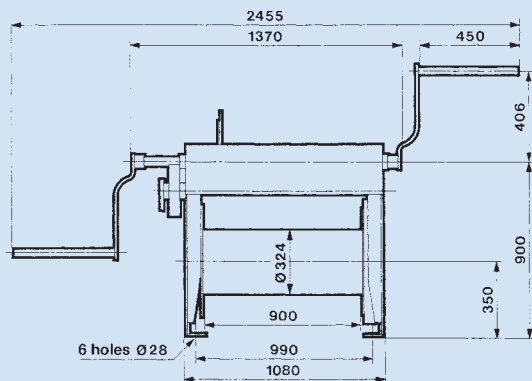
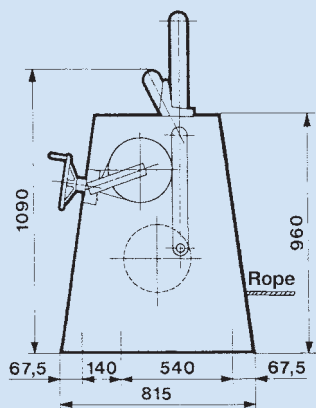

Capacity kg	A mm	B mm	C mm	D mm	E mm	F mm	Ø G mm	H mm	Capacity kg	Ø J mm	K mm	L mm	M mm	N mm	O mm	P mm	Lg mm
7500	2455	1370	1090	815	990	540	324	406	7500	28	350	900	1080	-	140	960	900

Capacity kg	Number of speeds	Rope dia mm**	Capacity drum m	Number of layers	Travel per crank revolution (mm)	Weight kg
7 500	2	18	403	6	40	550

The indicated rope diameter corresponds to the capacity on the last layer.  
\*\* Breaking load coeff. = 3

## Model 10 t

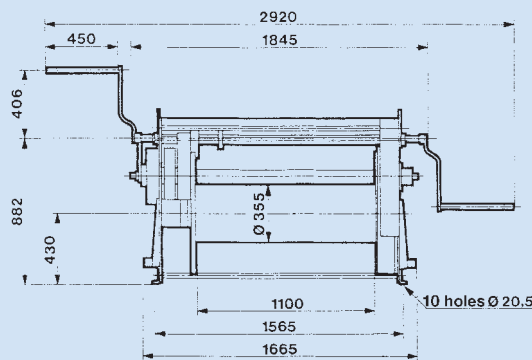
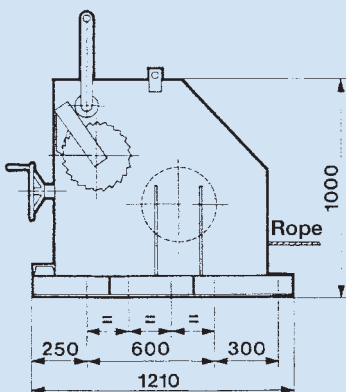

Capacity kg	A mm	B mm	C mm	D mm	E mm	F mm	Ø G mm	H mm	Capacity kg	Ø J mm	K mm	L mm	M mm	N mm	O mm	P mm	Lg mm
10000	2920	1845	-	1210	1565	600	355	406	10000	20.5	430	882	1665	-	250	1000	1100

Capacity kg	Number of speeds	Rope dia mm**	Capacity drum m	Number of layers	Travel per crank revolution (mm)	Weight kg
10 000	2	22	561	7	40	1100

The indicated rope diameter corresponds to the capacity on the last layer.  
\*\* Breaking load coeff. = 3

## Huchez, a complete range of lifting equipment

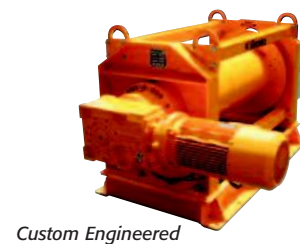

contact@huchez.fr



**HUCHEZ**  
60420 Ferrières (Oise) - France  
Tel. +33 344 511 133 - Fax +33 344 511 3 13

[www.huchez.fr](http://www.huchez.fr)