



Lifting brake winches TA and TPV series



- Supplied without cable.
- Removable handle.
- Galvanised steel and black plastique cover.
- TA winches for wall mounting application.

References

TPV series for standard mounting



TA series for wall mounting



Adaptation plate for direct tube mounting.



| Winch supplied without rope | | TPV900 | TPV1200 | TPV1600 | TA900 | TA1200 |
|--|-------------|---------|----------|-----------------|-----------|-----------------|
| Reference | | PF70901 | PF701201 | PF701601 | PF70902 | PF701202 |
| Lifting capacity (kg) | First layer | 700 | 900 | 950 | 700 | 900 |
| | Last layer | 325 | 500 | 560 | 325 | 500 |
| Rolling load capacity (kg) On 20% incline | | 1200 | 1600 | 1700 | - | - |
| Gear ratio | | 1/4,85 | 1/9,71 | 1/4,85 & 1/9,71 | 1/4,85 | 1/4,85 & 1/9,71 |
| Wire rope length | Ø 6 mm | 16 m | 13 m | 13 m | 15 m | 13 m |
| | Ø 7 mm | - | 10 m | 10 m | - | 10 m |
| Handle length (mm) | | 250 | 250 | 250 | 250 | 250 |
| Number of speeds | | 1 | 1 | 2 | 1 | 2 |
| Handle | | Fixed | Fixed | Removable | Removable | Removable |
| Winch weight (kg) | | 5,7 | 6,0 | 6,0 | 5,7 | 6,0 |
| Units per box | | 4 | 4 | 4 | 4 | 4 |

| Type | Reference |
|------------------------|-----------|
| Plate to weld | PF56415 |
| Plate to fix by screws | PF56414 |

Spare parts



Handle
Length 250 mm

| Type | Reference |
|-----------|-----------|
| Fix | PF56416 |
| Removable | PF56410 |



Cable grip

| Type | Reference |
|--------------------|-----------|
| TA/TPV 900 | PF56003 |
| TA/TPV 1200 & 1600 | PF56004 |

Dimensions and fixings (mm)

TPV series

| | TPV900 | TPV1200 | TPV1600 |
|---|--------|---------|---------|
| A | Ø11 | Ø11 | Ø11 |
| B | 24 | 24 | 24 |
| C | 70 | 70 | 70 |
| D | 22 | 22 | 22 |
| E | 24,5 | 24,5 | 24,5 |
| F | 28 | 28 | 28 |
| G | 130 | 130 | 130 |
| H | 36 | 36 | 36 |
| I | 48,5 | 48,5 | 48,5 |
| J | 250 | 250 | 250 |
| K | 186 | 186 | 186 |
| L | 390 | 343 | 343 |
| M | 212 | 212 | 212 |
| N | 119 | 119 | 119 |
| O | 246 | 273 | 273 |

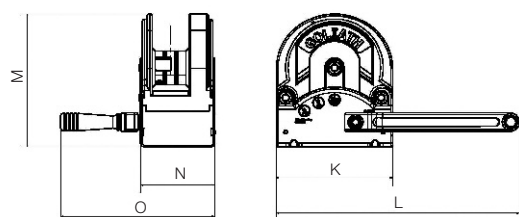
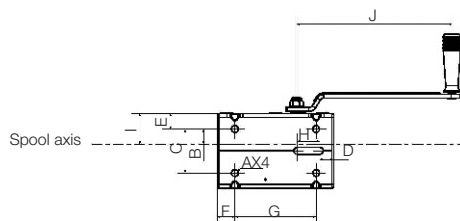

TA Series

| | TA900 | TA1600 |
|---|-------|--------|
| A | Ø11 | Ø11 |
| B | 24 | 24 |
| C | 70 | 70 |
| D | 28 | 28 |
| E | 24,5 | 24,5 |
| F | 130 | 130 |
| G | 48,5 | 48,5 |
| H | 250 | 250 |
| I | 86 | 86 |
| J | 140 | 140 |
| K | 186 | 186 |
| L | 390 | 343 |
| M | 23 | 23 |
| N | 43 | 43 |
| O | 20 | 20 |
| P | 60 | 60 |
| Q | 23 | 23 |
| R | 10,5 | 10,5 |
| S | 256 | 273 |
| T | 119 | 119 |
| U | 272 | 272 |

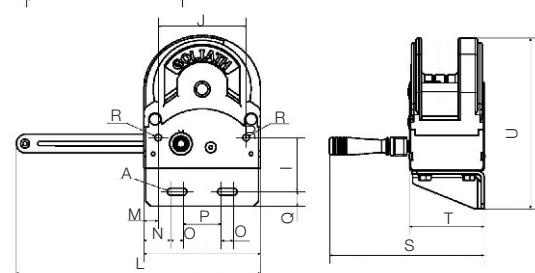
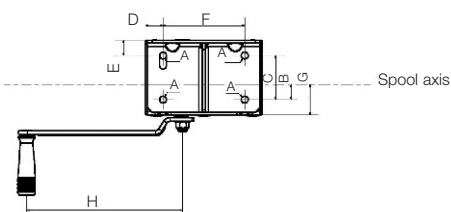

Adaptation plate

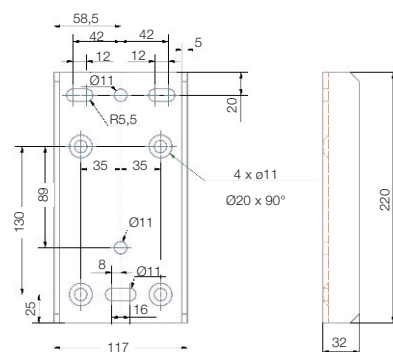

GOLIATH®

Bretteville Taljer & Maskiner AS
Griniveien 159
1359 Eiksmarka

Tel: +47 67 16 69 90
Fax: +47 67 16 68 10
www.brettevilletaljer.no
post@brettevilletaljer.no

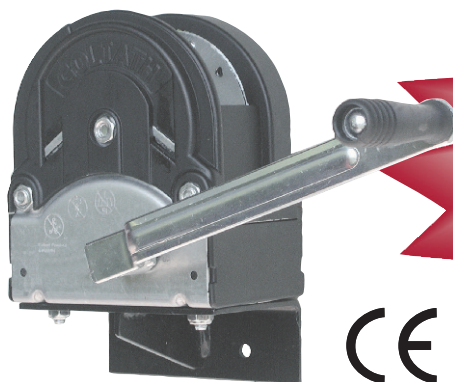

New

GOLIATH®

Lifting brake winches TA and TPV series

The **Goliath®** lifting winches of the **TA** and **TPV** series are equipped with a new generation of load brake, designed to offer **security**, the highest level of **reliability** as well as **maximum comfort of use**.

Security*

A permanent and reliable load brake :



- The internal load brake system is automatically activated as soon as the wire rope is under tension.
- The load is held by the brake system without action on the handle or even when the handle is removed.
- The mechanism is protected by the cover.

Designed for the user's comfort :



- Load brake allows to move heavy loads while reducing the effort on the handle (< 4kg downwards).
- Silent load brake.
- The cover prevents accidents.

New design

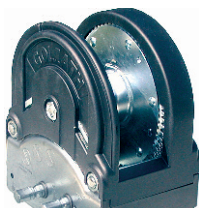

A complete protection :

- The cover protects the cable from gears damage and wear.
- The winch mechanism and gears are protected from corrosion and external damage.



Easy access for maintenance operation :

- The design of the Goliath drum allows easy mounting or replacement of the wire rope without disassembling the winch.

2 speeds = More comfort

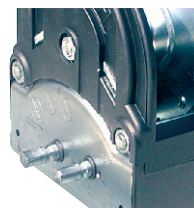

2 speeds winch (TPV1600) :

- Choice between 2 hauling speeds.
- Reduce the effort on the handle.
- Speed selection is achieved by changing the handle of shaft.

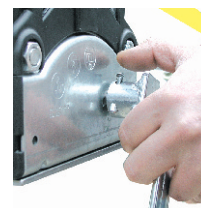

Removable handle with security lock :

- Security : Remove handle to restrict use of the winch.
- Allows the change of speed while the winch is in use.

Multipurpose : Wall mounting or standard mount



Wall mounting

The TA winch can be mounted on a wall.

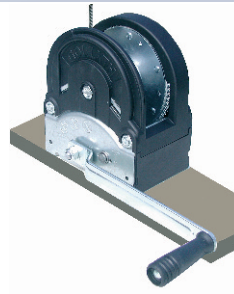
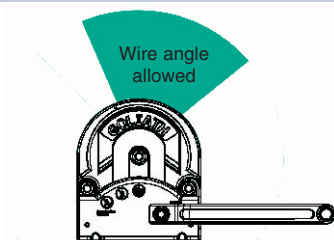

Standard mount

The TPV winch can be mounted on a plate.

